

Water



Hydrophore tank-STEELPEX

Execution :

- Steel tank for hydrophore **COMPLETELY PLASTICIZED – PE-LINING**
- Approved for potable water, UV, corrosion and chemical resistant.
- Vertical pressure vessel for fresh water
- Design Pressure 9 bar – Test Pressure 13 bar
- Temperature : -10°C / +60°C
- Conformity with Pressure Equipment Directive 2014-68-EU (PED)
- Connections: 5/4" F or 50 mm PVC + 3 x 1/2" F + drain 1/2" F

Type	Volume	ø Dia	Length/Height	Left/right	top/bottom
HV-200-9-STEELPEX	200 L	500	1455	-	DN 100
HV-300-9-STEELPEX	300 L	600	1600	-	DN 100

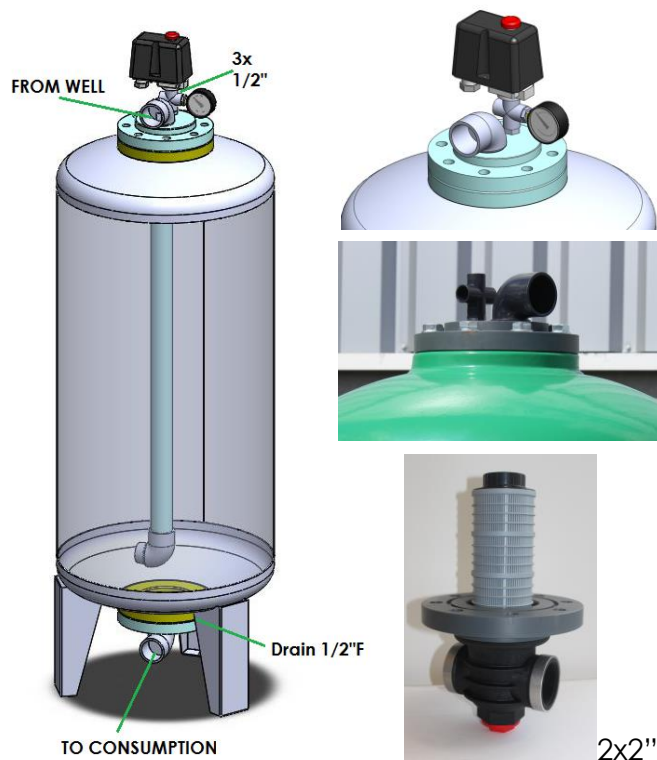

LORIVAN

Kachtemsestraat 165 • B-8800 Roeselare • Belgium
 T +32.51.20.23.91 • F +32.51.25.13.47
www.lorivan.be • info@lorivan.be

Water



Hydrophore tank-STEELPEX

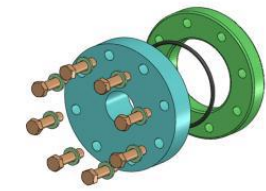
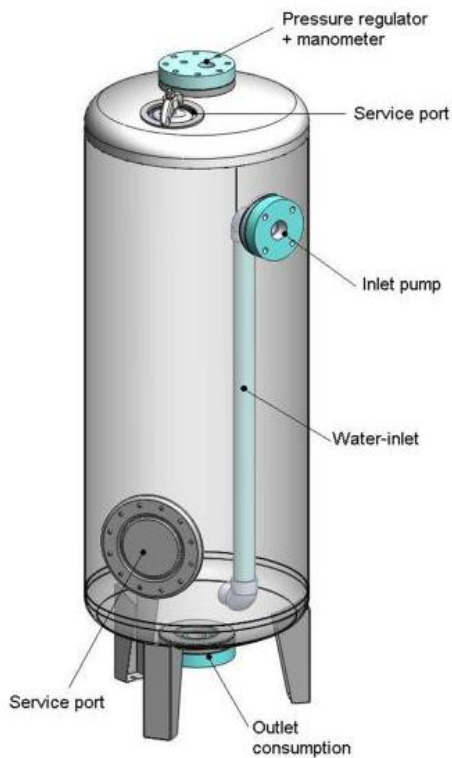

• Flange adaptors PVC,

- DN 65 – 2"
- DN 100 – 2"
- DN 100 - 3",
- DN 100 – ½" + 6/4"
- DN 100 - 1"
- DN 100 – 2x2"

Type	Ø Dia	Cilindr. Height	Volume Liter	Total Height	Weight Kg	Top flange	Bottom flange	Side flange	Inspection port (n°)	lateral service port	Central top manhole
HV-50-TBS	500	1500	320 L	1990	80kg	DN100	DN100	DN65	----	handhole 2	----
HV-65-TBS	650	1400	520 L	1960	110kg	DN100	DN100	DN65	handhole 1	DN 200	----
HV-75-TBS	750	1500	760 L	2090	155kg	DN100	DN100	DN65	handhole 1	DN 200	----
HV-80-TBS	800	1700	975 L	2420	175kg	DN100	DN100	DN65	handhole 1	DN 200	----
HV-90-TBS	900	1800	1300 L	2580	290kg	DN100	DN100	DN100	handhole 1	DN 200	----
HV-100-TBS	1000	1800	1650 L	2600	330kg	DN100	DN100	DN100	handhole 1	DN 200	----
HV-110-TBS	1100	1800	2000 L	2630	370kg	DN100	DN100	DN100	handhole 1	DN 200	----
HV-125-TBS	1250	1800	2775 L	3000	560kg	DN100	DN100	DN100	handhole 1	DN 200	DN 400

Kachtemsestraat 165 • B-8800 Roeselare • Belgium
 T +32.51.20.23.91 • F +32.51.25.13.47
www.lorivan.be • info@lorivan.be

